

Robust Capacitive Sensors:

- ✓ Patented Pulsed Antenna design and micro-processor controlled dynamic monitoring of the touch surface assures you of accurate switching in all environments including water, snow, ice and dirt.
- ✓ Time tested proven technology has been adapted for use with the most stringent automotive specifications.
- ✓ Off the shelf components are used to keep the cost as low as possible.
- ✓ Excellent performance in humid/wet environments
- ✓ Operating temperature -40°C to +125°C
- ✓ Standard micro-processor based operation
- ✓ Very low Quiescent Current $\leq 30\mu\text{A}$ (at 5V)

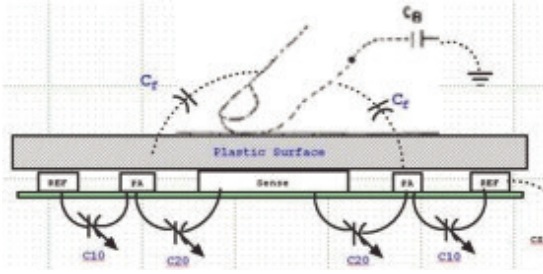

- ✓ LIN / CAN or serial communication
- ✓ Maximum response time $\leq 50\text{m sec}$
- ✓ Extremely low operating current possible — about $70\mu\text{A}$ or less at 3.5V
- ✓ Works with; curved surfaces; thin spaces
- ✓ 0 – 20mm air gap actuation response on interior switches; 0 – 5 mm response with rain compensation on exterior switches
- ✓ Low pressure / low temperature overmold process completely seals circuitry.
- ✓ Easily backlit

PASSIVE ENTRY SYSTEMS

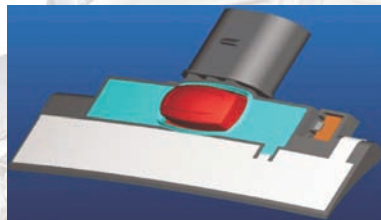

INTERIOR CONTROLS



781.297.6000

www.ark-les-transportation.com

Design and specifications subject to change without notice due to continuing product improvements

TW Ark-Les
TRANSPORTATION An ITW Switches Business
NON-CONTACT SENSING SOLUTIONS

For more information email us: info@ark-les-transportation.com or contact **Martin Foxworthy**, Sales Manager 248-514-8457